



**EIGHTYFOUR™**

**LP6827LBN / LP6827LBL**

(Lowes Item #5127853) / (Lowes Item #5218270)

## 84" Ceiling Fan

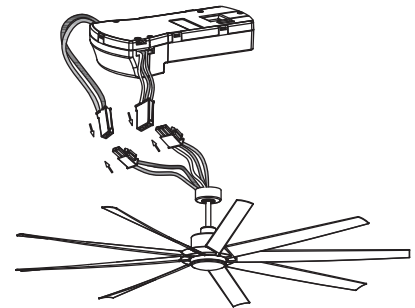
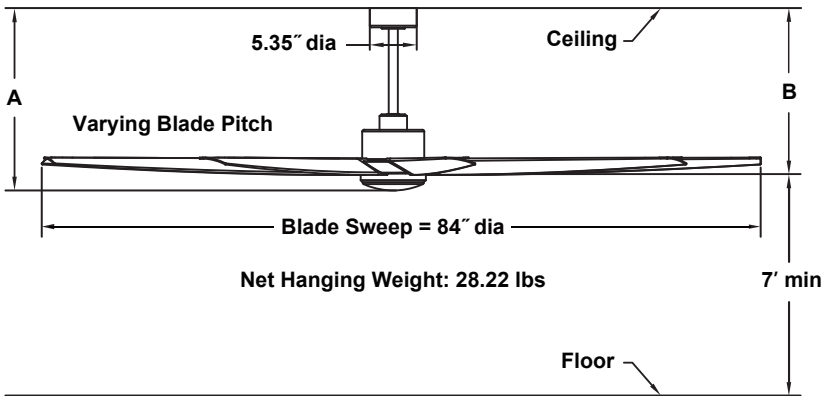

featuring KwikWire easy connection

### INSTALLATION REQUIREMENTS:

Fan must be attached to a securely anchored electrical junction box capable of withstanding a load of at least 35 lbs.

### ELECTRICAL REQUIREMENTS:

Requires a grounded electrical supply line of 120 volts AC, 60 Hz, 15 amp circuit.

### MOTOR SPECS:

DC135L DC motor is designed for optimal performance with this fan.

### BLADE SET:

A set of nine 38" composite blades is included.

### CONTROL OPTIONS:

TR305S hand-held remote control is included. Push button remote control with 16 fan speeds, fresh air, reverse, ON/OFF dimmer light levels, CCT Select (correlated color temperature selection), fan/light timer, home away, safe exit and off button. Optional TW306 wall control is available — sold separately. Instructions is provided with each control.

### LIGHTING OPTIONS:

One 24-watt CCT LED (Warm/Natural/Cool) included.

### DOWNROD OPTIONS:

Fan comes with a 1" dia. x 12" long downrod (DRT1-12). Optional downrods are available in 18", 24", 36", 48", 60" and 72". Fan can be mounted on a sloped ceiling up to 19°. Most sloped ceiling installations require a standard 24" downrod or longer downrod. Optional sloped ceiling kits (SCK1-52) are available for up to 42°. Optional close-to-ceiling kit is available as well — sold separately. Call technical support for more information.

### LOCATION USE:

Fan is rated for dry and damp locations. This fan is for room over 400 sq ft.

	A	B
Fan w/12" downrod	20.80"	18.95"
Fan w/18" downrod	26.80"	24.95"
Fan w/24" downrod	32.80"	30.95"
Fan w/36" downrod	44.80"	42.95"
Fan w/48" downrod	56.80"	54.95"
Fan w/60" downrod	68.80"	66.95"
Fan w/72" downrod	80.80"	78.95"

Available Finishes	
LBN	Brushed Nickel with Gray Blades and Opal Frosted Glass
LBL	Black with Black Blades and Opal Frosted Glass

Airflow / Energy Efficiency Info (120V)					
Fan Speed	Max RPM	CFM	CFM / Watts	Amps	Watts
High (16 <sup>th</sup> )	68	11975	350	0.47	34
Med (9 <sup>th</sup> )	51	8757	767	0.18	11
Low (1 <sup>th</sup> )	30	5617	1397	0.08	4

Energy Guide FTC			
Power (W <sub>ave</sub> )	Total Air Delivery (CFM <sub>ave</sub> )	Estimated Yearly Energy Cost (\$)	Ceiling Fan Efficiency (CFM/W)
22	8995	6	408

Lighting Information (120V)					
Light Bulb	Lumens Amount	Delivered Lumens	Color Temp	CRI	Shade/Glass type
24W CCT LED	2000	844/863/862	Warm/Natural/Cool	90%	Opal Frosted